



## 27 Alfred Close, London, Chiswick, W4 5UW

Ideally located in the heart of Chiswick, this stunning two bedroom ground floor flat boasts a modern interior and is close to transport links and local amenities of Chiswick High Road and Turnham Green Terrace.

- Two bedrooms
- Ground floor
- Off-street allocated parking
- Entirely refurbished
- Close to transport links
- Chain free

£500,000

# Alfred Close

Approximate Gross Internal Area  
678 sq ft - 63 sq m

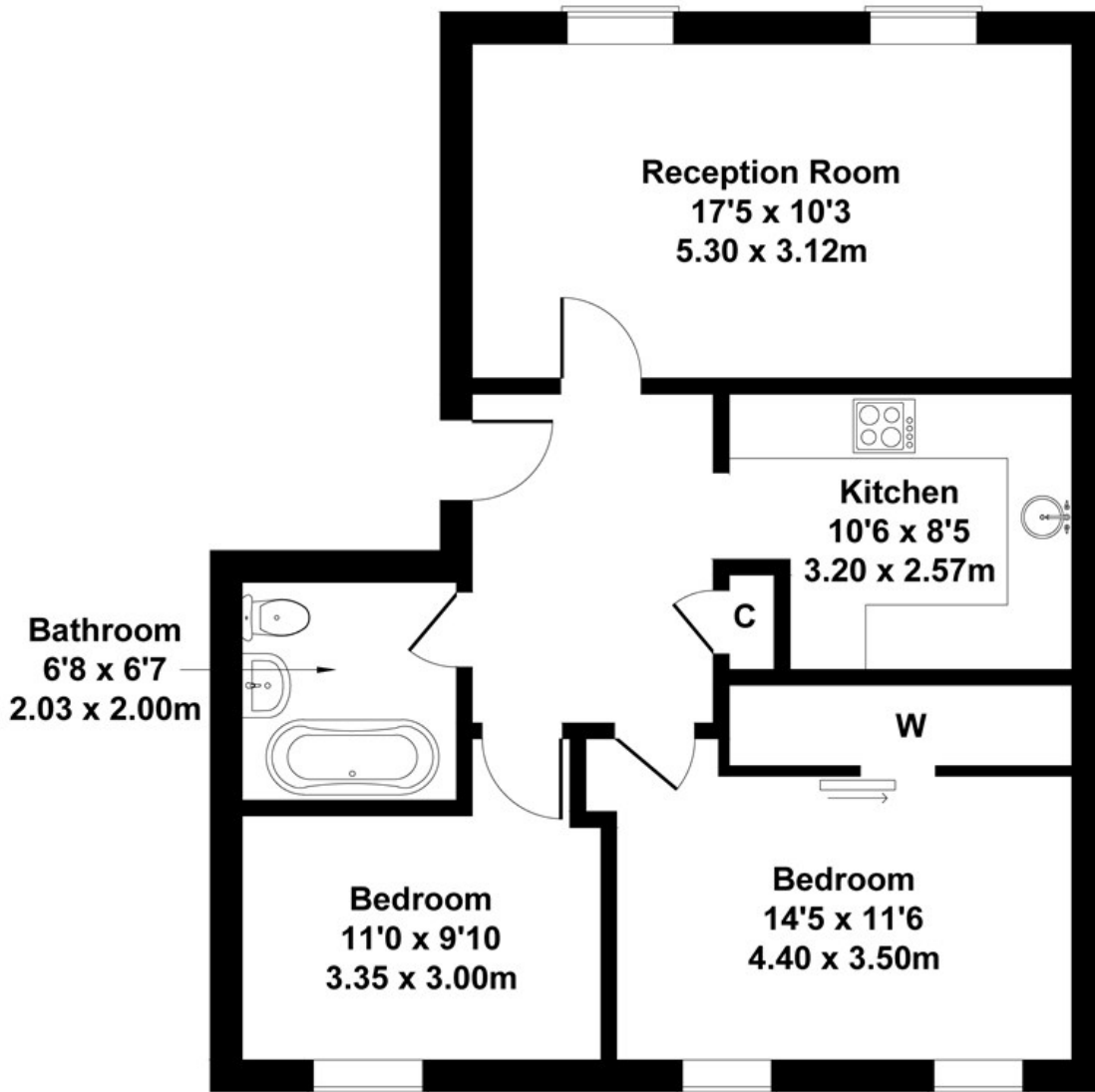
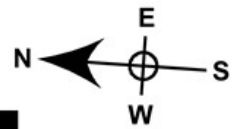

## GROUND FLOOR

Not to Scale. Produced by The Plan Portal 2023  
For Illustrative Purposes Only.

Energy Efficiency Rating		
	Current	Potential
Very energy efficient - lower running costs		
(92 plus) A		
(81-91) B		
(69-80) C	69	76
(55-68) D		
(39-54) E		
(21-38) F		
(1-20) G		
Not energy efficient - higher running costs		
England & Wales	EU Directive 2002/91/EC	